



The John Peel Theatre

General Information

We are a proscenium arch theatre, with a medium capacity auditorium space. We have a bar, as well as full backstage facilities. The full building is heated and has good domestic lighting.

Auditorium

Our auditorium is made up of 90, comfortable fabric seats. These are arranged in rows, on a raked floor system. 30 of our seats at the front of the seating are removable, and can be configured in any way, or removed entirely to allow some standing space at the front. They can also be individually removed to allow for wheelchair spaces.

There is an aisle down both sides of the seating system, which cuts along the front of the stage.

Entrance/exit to the auditorium is via 2 doors from the foyer area, and one door into the corridor, which exits the auditorium at the front right-hand side.

Bar & Refreshments

Our bar is licenced to serve a selection of alcoholic and non-alcoholic beers, as well as cider, real ales and wine. We also serve a selection of soft drinks such as juices, tea and coffee. The bar is open before the show, and during the interval. Ice creams are served in the auditorium during the interval, as well as at the bar before the show. The bar is managed by us.

Toilets

Our toilet facilities are made up of 3 enclosed unisex toilets, with a shared sink area. As well as this, we have an individual toilet with a sanitary bin and sink, as well as baby changing facilities. Our disabled toilet is wheelchair accessible and has supporting bars for assistance. There is a wheelchair accessible sink in this toilet. The disabled toilet facilities include an emergency assistance alarm.



Stage

Our stage is a proscenium arch stage, with a gracious amount of space, including a small amount of wing space.

Entrance to the stage is via our rear green room, from 2 doors, one stage left and one stage right. These enter the wings, which are narrow and run from upstage to downstage along each side.

Along stage left are the controls for our 2-tab tracks. House tabs are controlled from the stage right side.

13A power is available at the stage, 25A in total split from sockets in the stage left and stage wings. A hatch in the stage floor in the downstage centre position reveals a further 2 sockets.

We have a trap door which is located mid stage left, crawl space to the trap door is accessible from a small hatch in the green room.

Overhanging each wing is a small gallery, which is accessible from our first floor (stage left access is via dressing rooms). There is no access from the galleries directly to stage. The galleries are hazardous and are used as storage, and as such must be used with extreme caution.

Our stage is 7508mm from wall to wall, including the wings. The wings are approximately 100mm in width. From the rear wall to the proscenium arch is 4800mm. Our apron overhangs the proscenium arch by 850mm. On each side of the apron is a small set of stairs leading from the stage to the auditorium floor. Our stage height is 4270mm to the roof. Lower points are our mid stage tab track at 3370mm and 3270mm to our proscenium lighting bar.

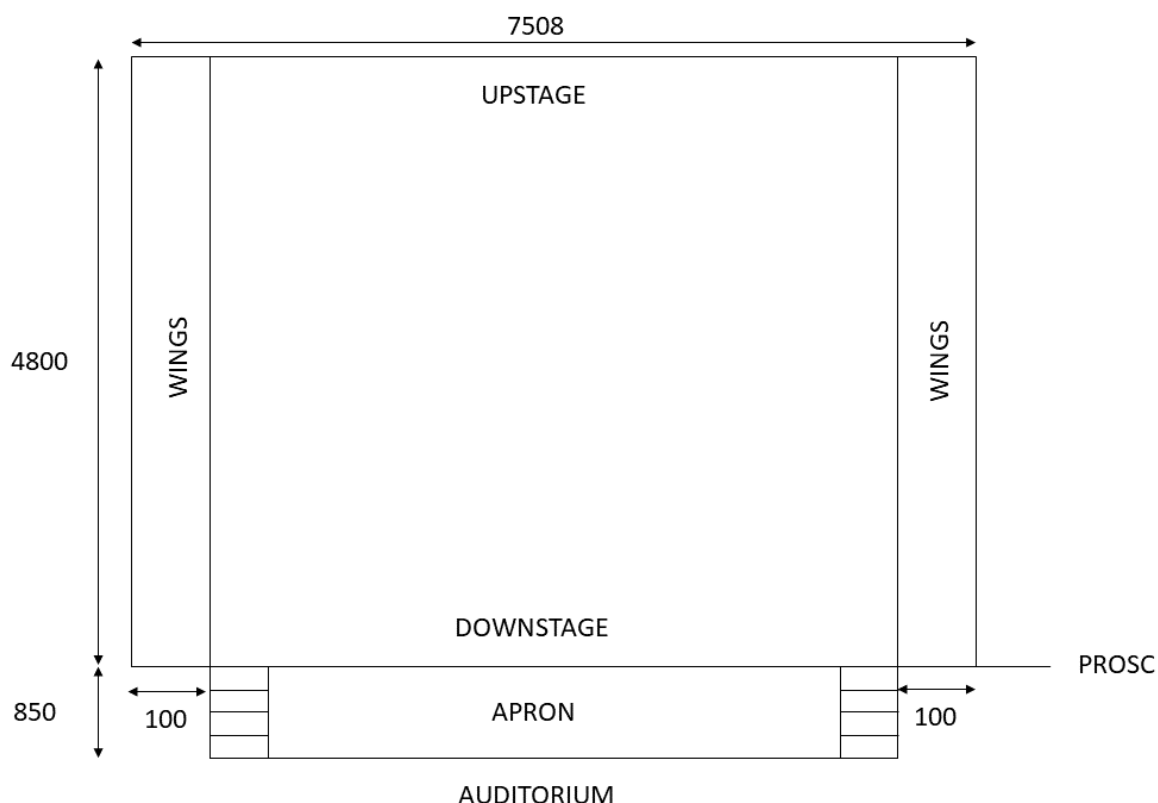



Green Room

Our green room is accessible from the side corridor, and has stage left and stage right access to the wings. There are kitchen facilities in the green room, with a sink, mugs, crockery and cutlery. Appliances include a small countertop fridge, microwave, kettle and dishwasher. There is also a messy sink in the green room for disposing of messy waste. There are recycling bins in the green room.

There is a long mirror and makeup area, with a small amount of space for seating. There are a few power sockets available. The First Aid Kit is in the green room. Storage shelves are available to store props.

A screen feeds a camera feed from the auditorium to the green room allowing cast members to see the stage. There is a stage audio feed into the green room also.

There is also a cast toilet accessible directly from the green room, with its own sink facilities.

Dressing Rooms

We have 4 dressing rooms. One is ground floor accessible from the green room and can fit 1-2 persons. This has a sink and some mirrors, plus hooks on the wall for hanging items.

The remaining dressing rooms are upstairs. The first floor contains 2 dressing rooms; however, one is only accessible through the other. These are relatively large dressing rooms and will accommodate between 3-5 persons each. A hanging rail is provided in each. The first dressing room also has auditorium camera feed displayed on a screen.

On our top floor attic level, we have 1 small dressing room. Height is limited in this dressing room, and standing area is only in half. The rest is suitable for seated/table use. This dressing room is only suitable for 1 person.

All dressing rooms have stage audio feed to allow performers to keep up with the show.



Parking

Parking is available for around 3-4 cars alongside the building. Long wheelbase vans will fit in our parking. LGVs will not fit. Additional payable parking is available in council car parks nearby.

Access

Access to the building is through the foyer for guests, or via the side 'stage door' entrance which can also be used for disabled access. Both are tight access doors with additional turns, this means large set items will be a struggle to get into the building.

Building Layout

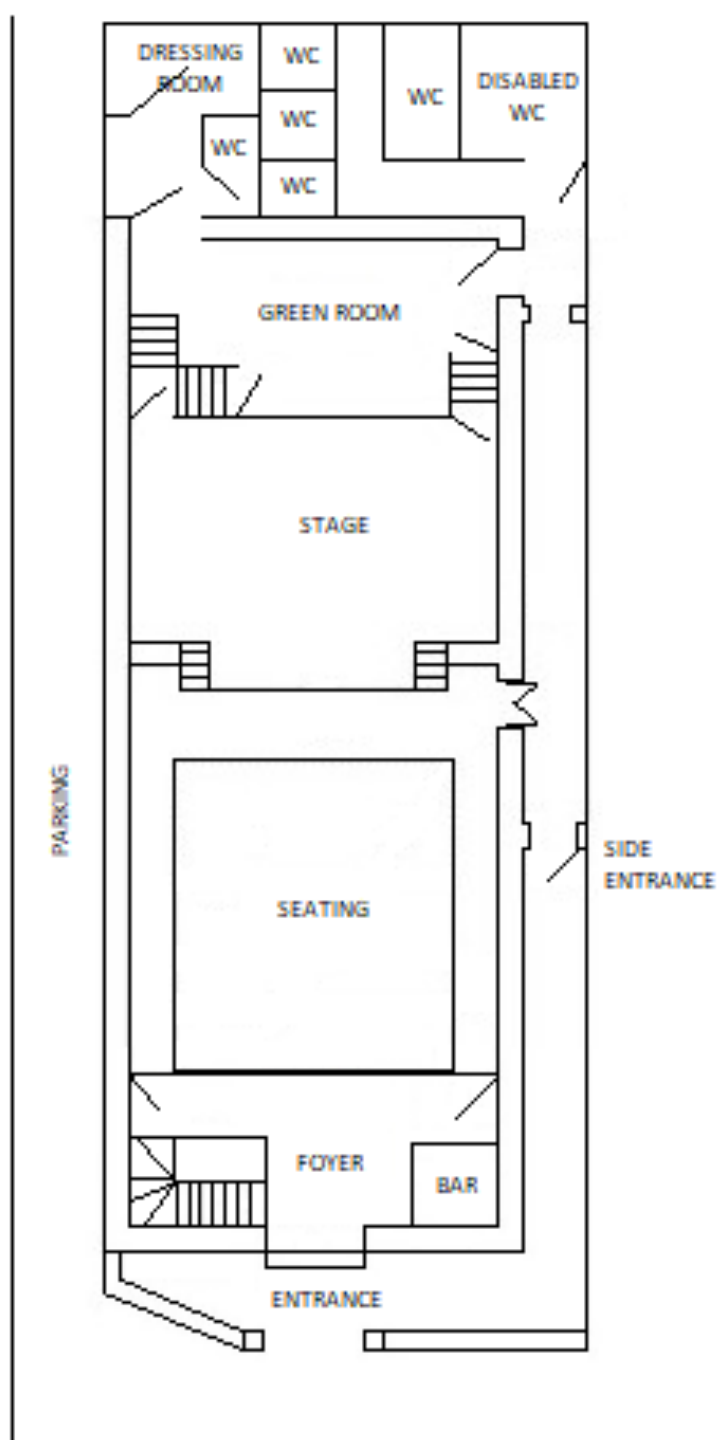



Hiring Us

Our theatre is available to hire for £300 a day. This includes all areas, plus all technical equipment listed in our technical specifications document. This price will also include at least 1x staff member, who will act as the duty manager, and fire supervisor. This rate is applicable should the theatre be used for a theatrical performance, concert, or corporate event.

We are open to ticket split arrangements, and these can be discussed on a case-by-case basis.

Discounts are available for charitable use of our theatre space, or for multiple show date bookings. These will also be discussed on a case-by-case basis.

Technician - £16 per hour – our technicians are fully trained to be able to provide lighting and sound requirements for your show.

Junior Technician - £10 per hour – our junior technicians can run simple lighting/sound for a show but have limited programming knowledge.

Should you not book extra staff, you will be expected to manage all technical equipment.

Our refreshments and bar will be open during your show unless specifically requested not to be and will be operated by our own staff. We will take all monies relating to bar sales.

We can manage your ticket sales through our TicketSource account. Ticket sale monies will be transferred to you following the event (this is a limitation of TicketSource) or deducted from your hire cost and the remainder transferred. We will charge £40 for the service of organising bookings per show run.

A non-refundable deposit of £150 is payable at the time of booking and the full amount payable post event.

If you have any further queries or concerns, please contact Aaron at:

theatrehire@wigtontheatre.org